



Kenton C. Ward, Surveyor

Phone (317) 776-8495

Fax (317) 776-9628

Suite 188

*One Hamilton County Square
Noblesville, Indiana 46060-2230*

December 7, 2005

To: Hamilton County Drainage Board

Re: Booth-Snead Drain

Attached is a petition and plans for the proposed relocation of the Booth-Snead Drain. The relocation is being proposed by Hills Communities. The proposal is to reconstruct the drain across parcels 13-11-34-00-35-045.000 owned by Hills Brookschool, LLC and 19-11-34-00-00-006.003 owned by Gray Eagle Golf, LLC as part of the Greystone Development project as shown on the plans by Stoepfelwerth and Associates, last revision dated March 17, 2005, Job Number 47405S1.

This line will consist of the following:

751 ft. of open drain

The total length of new open drain shall be 751 feet. The 675 feet of original drain between Sta. 29+35 and Sta.36+10 shall be vacated. This proposal will add an additional 76 feet to the drain total length.

Station 29+35 is the north line of the Greystone project. Sta. 36+10 is the northern limit of the previous reconstruction by Mays Property Management and referenced in my previous reports dated April 20, 2000 and October 31, 2000, as noted in Drainage Board Minutes Book 5, Pages 344 and 546 respectively.

The cost of the relocation is to be paid by Hills Communities.

The petitioner has provided the performance bond (letter of credit) as follows:

Name of Bonding Co./(Bank): National City

Bond/LC Number: S010467

Bond/LC Date: February 7, 2005

Bond/LC Amount: \$24,424.00

Bond/LC Term (1 Year Max): February 4, 2006

I recommend that upon approval of the above proposed drain that the Board also approve the attached non-enforcement request. The request is for the reduction of the regulated drain easement to those easements widths as shown on the secondary plat for Greystone as recorded in the office of the Hamilton County Recorder.

I recommend the Board set a hearing for this proposed drain for February 27, 2006

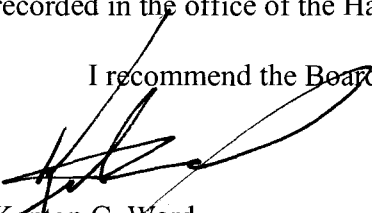

Kenton C. Ward
Hamilton County Surveyor

KCW/pll

HAMILTON COUNTY DRAINAGE BOARD
NOBLESVILLE, INDIANA

REVISED JUNE 1997

IN RE: _____)
Hamilton County, Indiana)

PETITION FOR RELOCATION AND RECONSTRUCTION

Hills Communities _____ (hereinafter "Petitioner"),

hereby petitions the Hamilton County Drainage Board for authority to relocate and improve a section of the Booth-Snead _____ Drain, and in support of said petition advises the Board that:

1. Petitioner owns real estate through which a portion of the Booth-Snead _____ Drain runs.
2. Petitioner plans to develop its real estate with roads, buildings, utilities, storm drains, sanitary sewers and other structures.
3. Petitioner's proposed development of its real estate will require relocation and reconstruction of a portion of the Booth-Snead _____ Drain, as specifically shown on engineering plans and specifications filed with the Hamilton County Surveyor.
4. The work necessary for the proposed relocation and reconstruction will be undertaken at the sole expense of the Petitioner and such work will result in substantial improvement to the Booth-Snead _____ Drain, without cost to other property owners on the watershed of the Booth-Snead _____ Drain.
5. Proposed relocation and reconstruction will not adversely affect other land owners within the drainage shed.
6. Petitioner requests approval of the proposed relocation and reconstruction under IC 36-9-27-52.5.

WHEREFORE, Petitioner requests that an Order issued from the Hamilton County Drainage Board authorizing relocation and reconstruction of the Booth-Snead _____ Drain, in conformance with applicable law and plans and specifications on file with the Hamilton County Surveyor.

Signed _____
Printed STEVE RANSHAW

FINDINGS AND ORDER

CONCERNING THE PARTIAL VACATION OF THE

Booth Snead Drain, Sta. 29+35 to Sta. 36+10

On this **27th day of February 2006**, the Hamilton County Drainage Board has held a hearing on the Maintenance Report and Schedule of Assessments of the **Booth Snead Drain, Sta. 29+35 to Sta. 36+10**.

Evidence has been heard. Objections were presented and considered. The Board then adopted an order of action. The Board now finds that the costs of continued maintenance to the portion of the above drain exceed the benefits to the real estate benefited by the portion of the drain to be abandoned and issues this order vacating the above section of the **Booth Snead Drain**.

HAMILTON COUNTY DRAINAGE BOARD



President

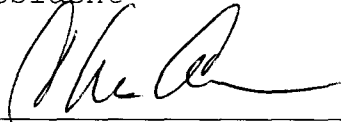

Member

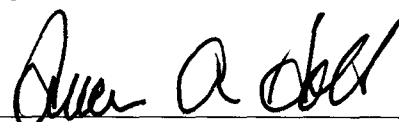

Member

Attest: 

STATE OF INDIANA)
) ss:
COUNTY OF HAMILTON)

BEFORE THE HAMILTON COUNTY
DRAINAGE BOARD
NOBLESVILLE, INDIANA

IN THE MATTER OF THE
RECONSTRUCTION OF THE
Booth Snead Drain, Relocation

FINDINGS AND ORDER FOR RECONSTRUCTION

The matter of the proposed Reconstruction of the **Booth Snead, Relocation** came before the Hamilton County Drainage Board for hearing **on February 27, 2006**, on the Reconstruction Report consisting of the report and the Schedule of Damages and Assessments. The Board also received and considered the written objection of an owner of certain lands affected by the proposed Reconstruction, said owner being:

Evidence was heard on the Reconstruction Report and on the aforementioned objections.

The Board, having considered the evidence and objections, and, upon motion duly made, seconded and unanimously carried, did find and determine that the costs, damages and expenses of the proposed Reconstruction will be less than the benefits accruing to the owners of all land benefited by the Reconstruction.

The Board having considered the evidence and objections, upon motion duly made, seconded and unanimously carried, did adopt the Schedule of Assessments as proposed, subject to amendment after inspection of the subject drain as it relates to the lands of any owners which may have been erroneously included or omitted from the Schedule of Assessments.

The Board further finds that it has jurisdiction of these proceedings and that all required notices have been duly given or published as required by law.

Wherefore, it is ORDERED, that the proposed Reconstruction of the **Booth Snead Drain, Relocation** be and is hereby declared established.

Thereafter, the Board made inspection for the purpose of determining whether or not the lands of any owners had been erroneously included or excluded from the Schedule of Assessments. The Board finds on the basis of the reports and findings at this hearing as follows:

HAMILTON COUNTY DRAINAGE BOARD

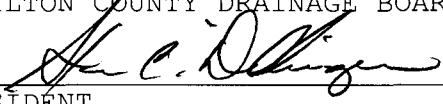
PRESIDENT

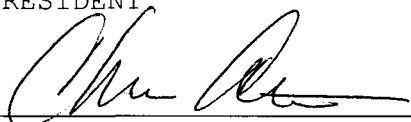
Member

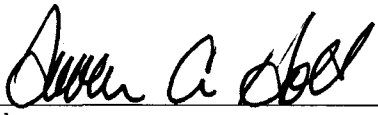
Member

ATTEST: 
Executive Secretary

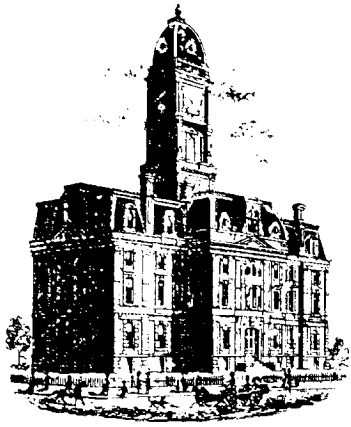

SURVEYOR'S OFFICE
Hamilton County

Kenton C. Ward, CFM
Surveyor of Hamilton County
Phone (317) 776-8495
Fax (317) 776-9628

Suite 188
One Hamilton County Square
Noblesville, Indiana 46060-2230

To: Hamilton County Drainage Board

March 14, 2008

Re: Mud Creek –Sand Creek: Booth Snead Relocation

Attached are as-builts, certificate of completion & compliance, and other information for the Booth-Snead Relocation for Greystone. An inspection of the drainage facilities for this section has been made and the facilities were found to be complete and acceptable.

During construction, changes there were no significant changes made to the drainage plans submitted with my report for this drain dated December 7, 2005. The report was approved by the Board at the hearing held February 27, 2006. (See Drainage Board Minutes Book 9, Pages 80-82) Therefore, the length of the drain remains at **751 feet**.

The non-enforcement was approved by the Board at its meeting on February 27, 2006 and recorded under instrument #200600019141.

The following sureties were guaranteed by National City and released by the Board on its November 12, 2005 meeting.

Bond-LC No: S010467
Insured For: Storm Sewers
Amount: \$24,424.00
Issue Date: February 7, 2005

I recommend the Board approve the drain's construction as complete and acceptable.

Sincerely,

Kenton C. Ward, CFM
Hamilton County Surveyor

KCW/slm

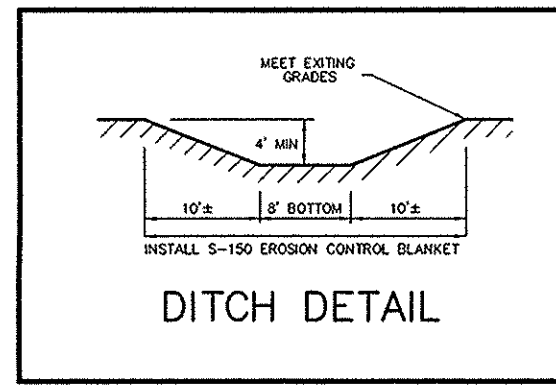
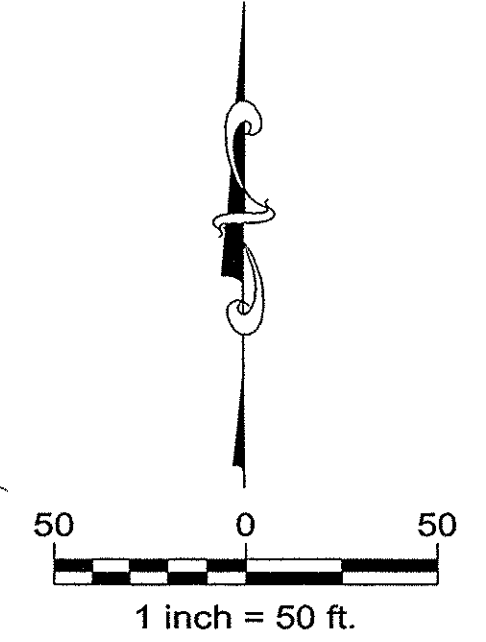
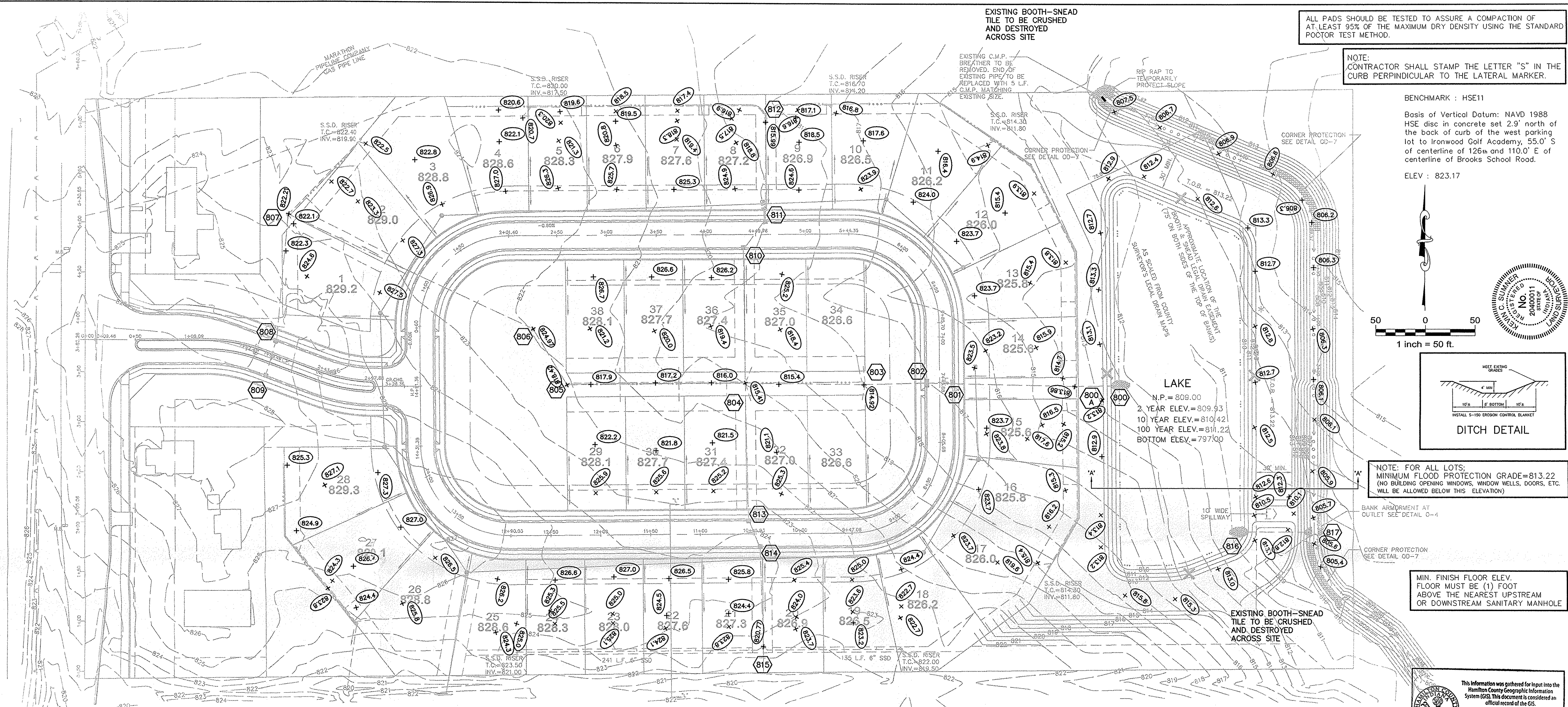

MIN. FINISH FLOOR ELEV. FLOOR MUST BE (1) FOOT ABOVE THE NEAREST UPSTREAM OR DOWNSTREAM SANITARY MANHOLE

This information was gathered for input into the Hamilton County Geographic Information System (GIS). This document is considered an official record of the GIS.

Entry Date: 3-14-08
Entered By: SLM

SCALE: 1"=50' HOR.
1"=5' VERT.

RECORD DRAWING

Jeffery W. Darling
Jeffery W. Darling
Registered Land Surveyor
No. 900017

6/22/05
DATE

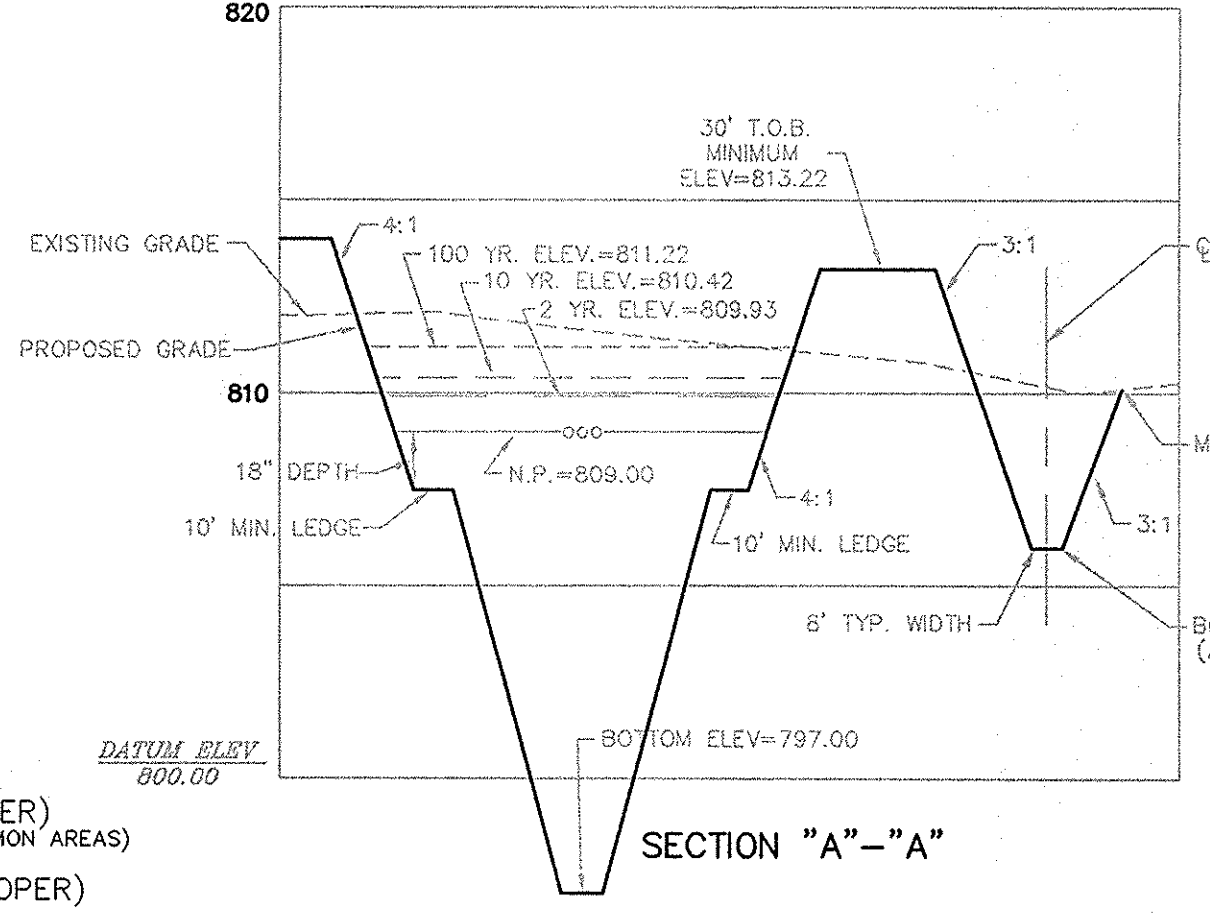
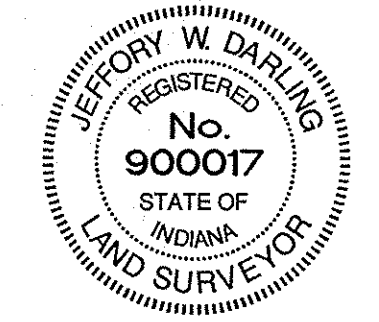

SCALE: 1"=50' HOR.
1"=5' VERT.

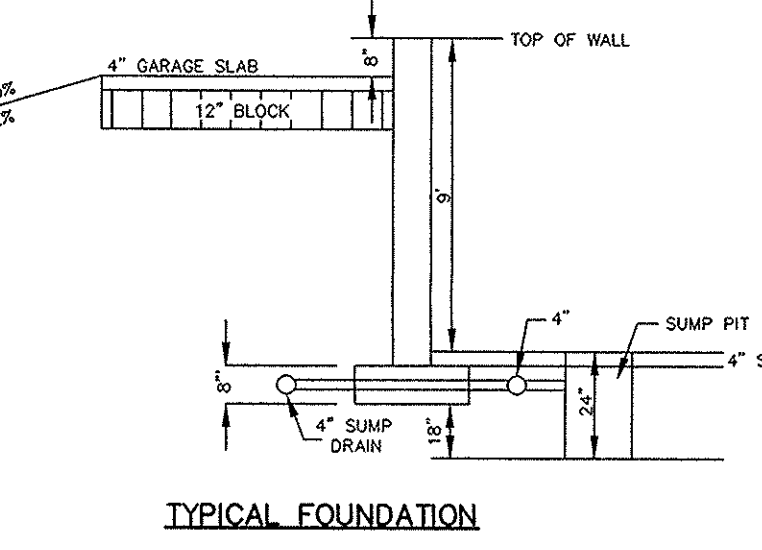
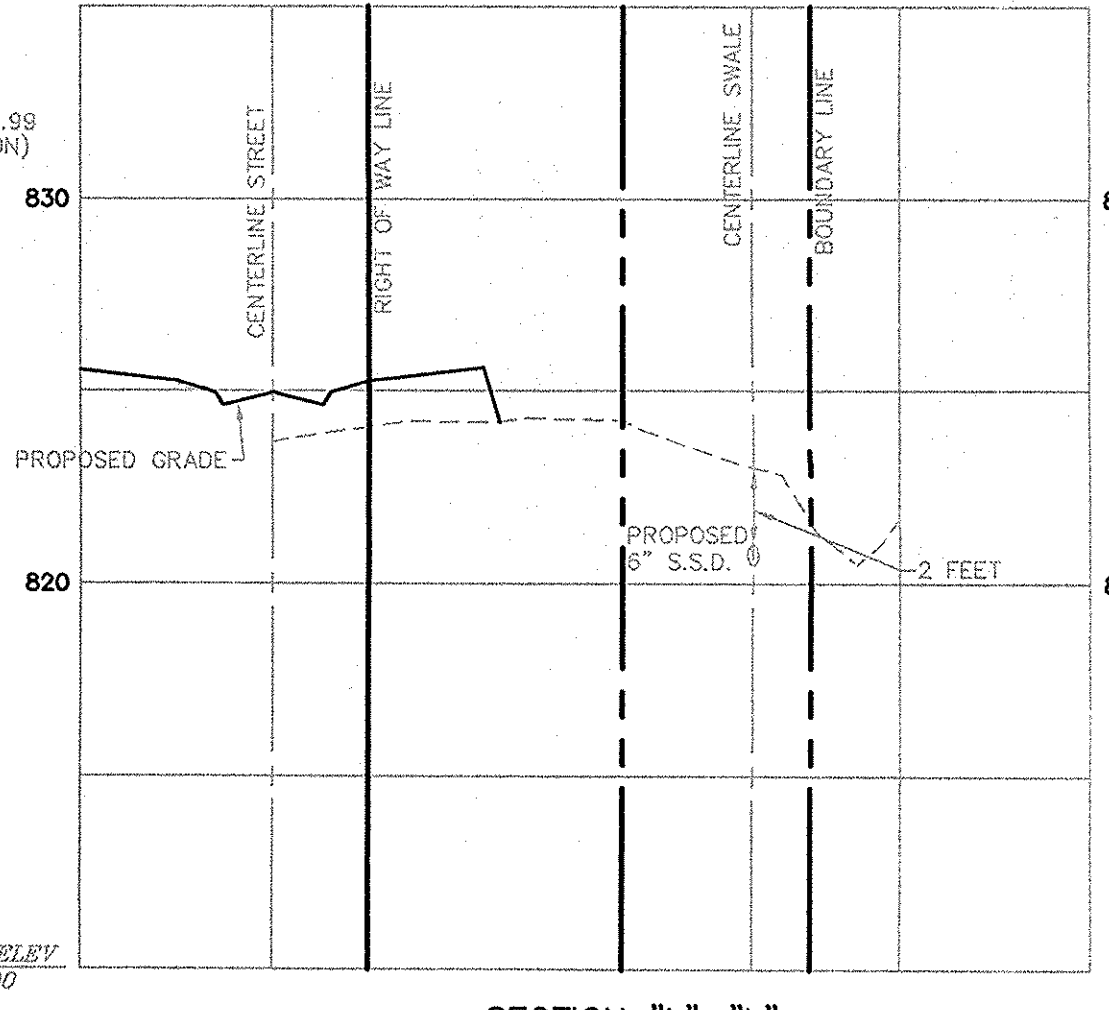

CAUTION
LOCATION OF ALL EXISTING UNDERGROUND UTILITIES SHOWN ON THIS PLAN ARE BASED UPON ABOVE GROUND EVIDENCE. (including, but not limited to, manholes, inlets, valves, & markers made upon the ground by others.) AND ARE SPECULATIVE IN NATURE. THERE MAY ALSO BE OTHER EXISTING UNDERGROUND UTILITIES FOR WHICH THERE IS NO ABOVE GROUND EVIDENCE OR FOR WHICH NO ABOVE GROUND EVIDENCE WAS OBSERVED. THE EXACT LOCATIONS OF SAID EXISTING UNDERGROUND UTILITIES SHOULD BE VERIFIED BY THE CONTRACTOR PRIOR TO ANY AND ALL CONSTRUCTION.

1-800-382-5544
CALL TOLL FREE
1-800-428-5200
FOR CALLS OUTSIDE OF INDIANA

- EARTHWORK:
- EXCAVATION
 - Excavated material that is suitable may be used for fills. All unsuitable material and all surplus excavated material not required shall be removed from the site.
 - Provide and place any additional fill material from offsite as may be necessary to produce the grades required on plans. Fill obtained from offsite shall be of quality as specified for fills herein and the source approved by the Developer. It will be the responsibility of the Contractor for any costs for fill needed.
 - REMOVAL OF TREES
 - All trees and stumps shall be removed from areas to be occupied by a road surface or structure area. Trees and stumps shall not be buried on site.
 - PROTECTION OF TREES
 - The Contractor shall, at the direction of the Developer, endeavor to save and protect trees of value and worth which do not impair construction of improvements as designed.
 - In the event cut or fill exceeds 0.5 foot over the root area, the Developer shall be consulted with respect to protective measure to be taken, if any, to preserve such trees.
 - REMOVAL OF TOPSOIL
 - All topsoil shall be removed from all areas beneath future pavements or building. Topsoil removal shall be to a minimum depth of 6 inches or to the depth indicated in the geotechnical report provided by the Developer to be excavated or filled. Topsoil should be stored at a location where it will not interfere with construction operations. The topsoil shall be free of debris and stones.
 - UTILITIES
 - Rules and regulation governing the respective utility shall be observed in executing all work under this section.
 - It shall be the responsibility of the Contractor to determine the location of existing underground utilities 2 working days prior to commencing work. For utility locations to be marked call Toll Free 1-800-382-5544 within Indiana or 1-800-428-5200 outside Indiana.
 - SITE GRADING
 - Do all cutting, filling, compacting of fills and rough grading required to bring entire project area to subgrade as shown on the drawing.
 - The tolerance for paved areas shall not exceed 0.10 feet above established subgrade. All other areas shall not exceed 0.10 feet plus or minus the established grade. Provide roundings at top and bottom of banks and other breaks in grade.
 - The Engineer shall be notified when the Contractor has reached the tolerance as stated above, so that field measurements and spot elevations can be verified by the Engineer. The Contractor shall not remove his equipment from the site until the Engineer has verified that the job meets the above tolerance.

- LEGEND
- EXISTING CONTOUR
 - EXISTING SANITARY SEWER
 - EXISTING STORM SEWER
 - PROPOSED GRADE
 - PROPOSED CONTOUR
 - PROPOSED SANITARY SEWER
 - PROPOSED STORM SEWER
 - PROPOSED SWALE
 - PROPOSED 5' SIDEWALK (BY HOME BUILDER) (DEVELOPER SHALL INSTALL SIDEWALKS ALONG ALL COMMON AREAS)
 - PROPOSED 8' ASPHALT PATH (BY DEVELOPER)
 - PROPOSED POND SAFETY SIGN
 - LOT NUMBER
 - MINIMUM FIRST FLOOR ELEVATION
 - M.B. MAIL BOX
 - T.C. TOP OF CASTING
 - G.U.T. GUTTER
 - INV. INVERT
 - M.E. MATCH EXISTING GRADE
 - L.P. PROPOSED LOW POINT
 - H.P. PROPOSED HIGH POINT

STORM CHART

STR. NO.	STRUCTURE	TYPE	T.C./RIM	INVERTS	DIR.
800	CONC. END SECTION			809.00	E
800A	MANHOLE	MANHOLE RT	814.00	809.43	E
801	DB. CURB INLET (TL)	CATCH BASIN A W/WHC	822.40	810.85	E
802	DB. CURB INLET (TR)	CATCH BASIN A W/WHC	822.40	810.85	E
803	YARD INLET	INLET A	812.40	811.84	E
804	YARD INLET	INLET A W/WHC	812.40	812.27	E
805	YARD INLET	INLET A	812.40	812.27	E
806	MANHOLE	MANHOLE	825.00	818.09	SW
807	YARD INLET	MANHOLE	827.80	818.50	SW
808	CURB INLET (TL)	MANHOLE	824.81	820.03	NE
809	CURB INLET (TR)	MANHOLE	824.81	820.43	NE
810	CURB INLET (TR)	CATCH BASIN A W/WHC	824.16	813.08	S
811	CURB INLET	CATCH BASIN A W/WHC	824.04	813.31	SW
812	YARD	MANHOLE H	818.90	813.90	S
813	CURB INLET (TL)	CATCH BASIN A W/WHC	824.16	815.50	N
814	CURB INLET (TR)	CATCH BASIN A W/WHC	824.10	815.70	NW
815	YARD INLET	INLET A	820.90	817.80	N
816	CONC. END SECTION			809.00	E
817	CONC. END SECTION			806.81	E

REVISIONS

NO.	DATE	BY	REVISIONS
1	10/01/04		

CERTIFIED: 10/01/04

CONSULTING ENGINEERS - LAND SURVEYORS
FISHERS INDIANA
(317) 849-5935 1-800-728-6917 FAX: (317) 849-5942

SHEET NO. C200
JOB NO. 4740551